

- LG42-TNTC Finish(C) ☐
- LG42-TNTK Finish(K) ☐
- LG42-TNTB Finish(B) ☐
- LG42-TNTBG Finish(BG) ☐

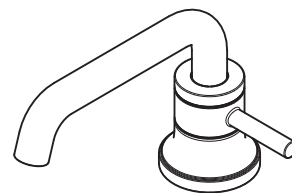

Specifications

Features

- 1.2 GPM Flow Rate
- All Metal Construction
- 1-Hole Installation (For 3-Hole Installation Order Deckplate)
- Optional Deckplate, Order 961-235*
- Order Install Kit 962-122 For Decks That Are Thinner Than 1/2" [12.7]
- All Metal Push & Seal™ Drain
- Mounting Hardware Included
- Forward Rotating Handle
- Temperature Only Control
- Metal Lever Handle
- Laminar Water Flow
- Pforever Seal Ceramic Disc Valve
- Pforever Warranty®

Code Compliance

Pfister products are designed and manufactured in compliance with the following standards and codes:

- IAPMO Certified to ASME A112.18.1/CSA B125.1
- NSF 61/9 AnnexG Certified
- EPA WaterSense Certified
- CEC Certified/CALGreen compliant
- ADA Compliant - ANSI A117.1 (Lever Handles Only)



Dimensions

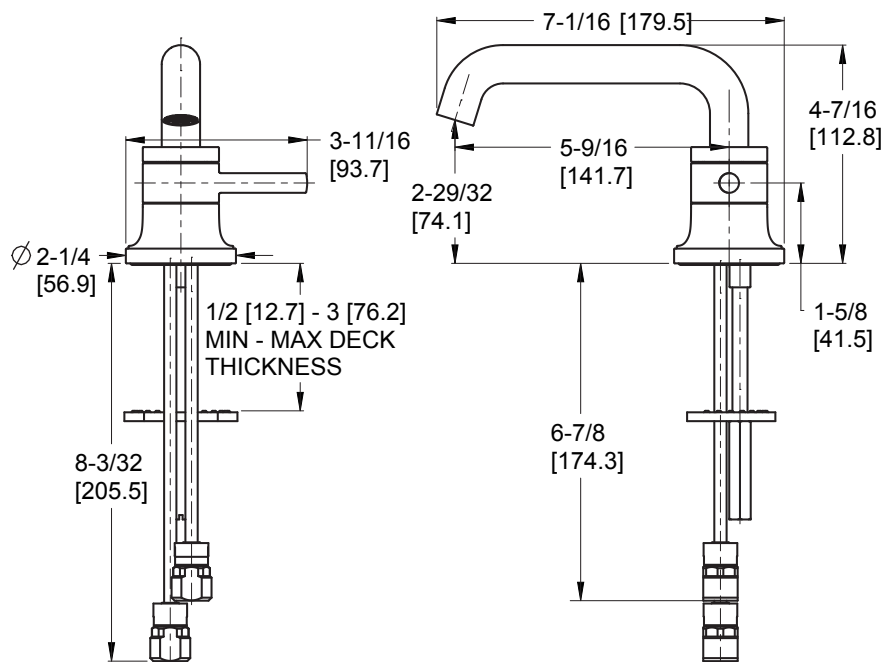

Ø1 Min to Ø1-1/2 Max. Deck Hole Openings

Forward Rotating Handle Function

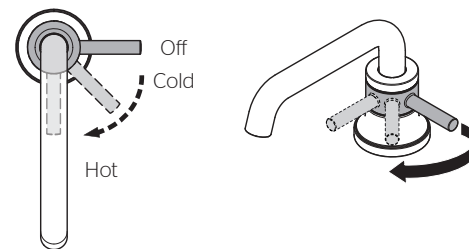

Optional Deckplate

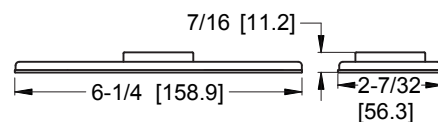

Metal Push & Seal™

