

- G134-5000 Finish(PC) ☐
- G134-6000 Finish(PC) ☐
- G134-7000 Finish(PC) ☐
- G134-700S Finish(SS) ☐

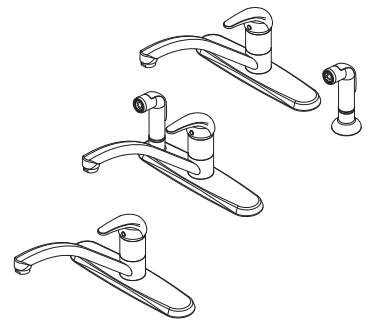

## Specifications

### Features

- 1.8 GPM Flow Rate
- Includes Metal Supply Nuts
- 3-Hole Installation (500\* & 600\* Only)
- 4-Hole Installation (700\* Only)
- Swivel Spout
- Includes Matching Side Spray (600S\* & 700S Only)
- Chrome Spray (6000 & 7000 Only)
- Stainless Steel Side Spray (600S & 700S Only)
- Pforever Seal™ Ceramic Disc Valve
- Limited Lifetime Warranty

### Code Compliance

Pfister products are designed and manufactured in compliance with the following standards and codes:

- IAPMO Certified to ASME A112.18.1/CSA B125.1 including:
  - ASME A112.18.3 (Backflow Prevention)
- NSF/ANSI/CAN61:Q≤1
- CEC Certified/CALGreen compliant
- ADA Compliant - ANSI A117.1 (Lever Handle Only)



## Dimensions

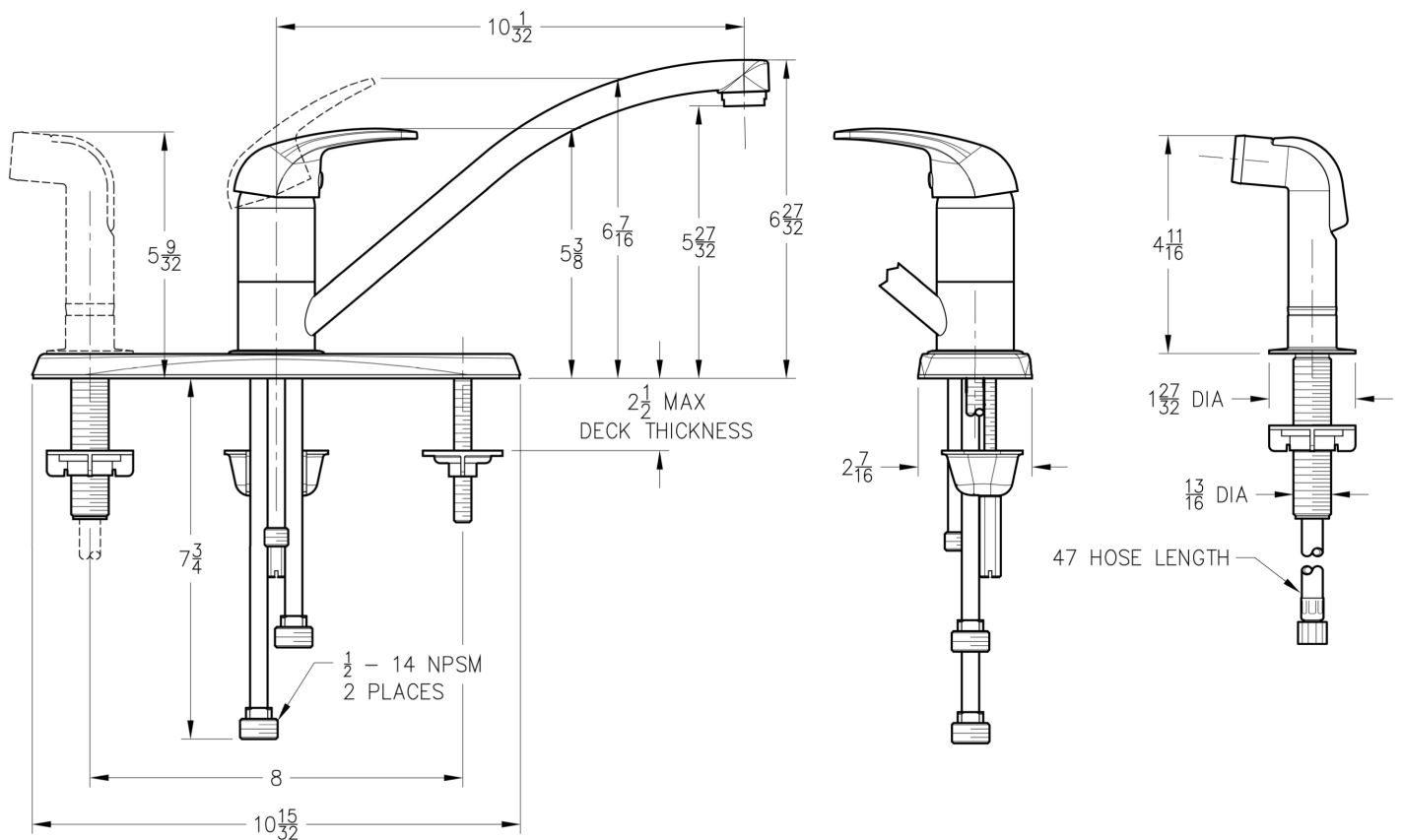

Ø1-3/8 Min to Ø1-1/2 Max. Deck Hole Openings